

LA1634

**Lock-Fit Shade:
Cone, Satin Glass**

Catalog No. _____

Type _____

Project _____



Orchard Field Glass is a unique collection of pendant shades that combine contemporary shapes and universal colors for virtually any application. These shades are designed for Con-Tech's Lock-Fit pendant fixtures.

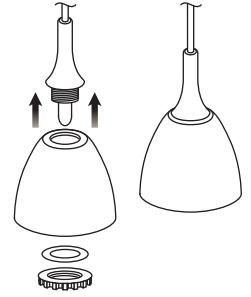

Lock-Fit Assembly

See Shade/Pendant Compatibility Chart for specific usage.

Dimensions: 2-7/8" H x 4-3/4" Dia.



Amber

LA1634-A



Green

LA1634-G



Blue

LA1634-B



Purple

LA1634-PR



Frost

LA1634-F



Red

LA1634-R

Shade/Pendant Compatibility Chart

Shade	Product Line	Pendant Part Number
LA1634	Odyssey Line Voltage Flexible Track	LIR3296
	Quick Release Low Voltage System	CRS3296QR
	Symphony Low Voltage Mini-Track	MRL-1624N
		MRL-1648N
		MRL-1696N
	Line Voltage Track	RLM16/BLK
		RLM16/WHT
	Line Voltage Mono-Point	LICM75096

